

Rear Mount Under Counter Refrigerator



GUR-28-HC



GUR-36-HC



GUR-48-HC



GUR-60-HC



GUR-72-HC

Features & Benefits

System

- Digital temperature control & monitor
- Hot gas condensate system
- Automatic evaporation & defrost system

Temperature

- Enhanced Airflow Holds Product Temperature 32°F~41°F (0°C~5°C)

Components

- 5" Heavy-duty casters with brakes standard

Slight Variations May Exist

Strong & Durable Cabinet Finish

- Stainless steel finished top, front, sides and doors
- Galvanized steel finished back and bottom
- PE coated sturdy wire shelves

User Friendly Door

- Auto-closing doors
- Sturdy and easy-grip handles and doors that open effortlessly
- Door pressure release device
- Magnetic door gasket provides an easy-to-remove feature for cleaning or replacement feature

Options

- Drawer mixed model available
- Leg models available

Plan View

GUR-28-HC

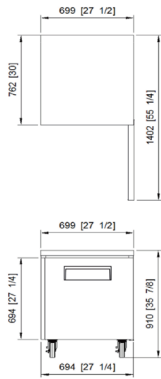

GUR-36-HC

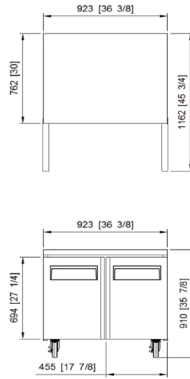

GUR-48-HC

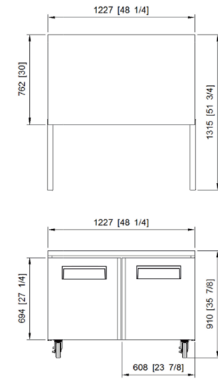

GUR-60-HC

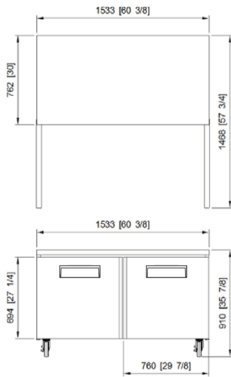

GUR-72-HC

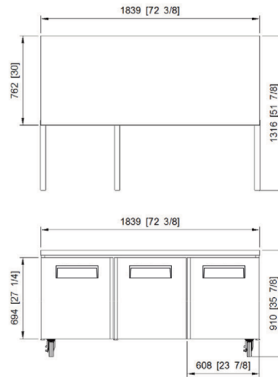

ALL SIDE

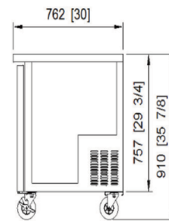

Specifications

Model	Capacity (cu.ft/ℓ)	Exterior Dimension (Inch/mm)			Net Weight (lb/kg)	Gross Weight (lb/kg)	Amps	Voltage (V/Hz/Ø)	HP	Refrigerant	No. Shelves	No. Doors
		W	D	H								
GUR2-8-HC	6.55	27 1/2	30	35 7/8	134	143	3.2	115/60/1	1/5	R-290	1	1
	186	699	762	910	61	65	2.0	220/50,60/1				
GUR-36-HC	8.92	36 3/8	30	35 7/8	170	181	3.2	115/60/1	1/5	R-290	2	2
	252	923	762	910	77	82	2.0	220/50,60/1				
GUR-48-HC	12.23	48 1/4	30	35 7/8	209	227	3.2	115/60/1	1/5	R-290	2	2
	346	1,227	762	910	95	103	2.0	220/50,60/1				
GUR-60-HC	15.56	60 3/8	30	35 7/8	231	254	6.0	115/60/1	3/8	R-290	2	2
	441	1,533	762	910	105	115	3.2	220/50,60/1				
GUR-72-HC	18.75	72 3/8	30	35 7/8	267	295	6.1	115/60/1	3/8	R-290	3	3
	531	1,839	762	910	121	134	3.2	220/50,60/1				

* External dimensions include 5" caster height

GRAND has the right to change specifications without further notice.



Grand Manufacturing LLC
www.grandmfgllc.com

