

## Direct Draw Beer Dispenser



**GBD-23B-HC**



**GBD-59B-HC**



**GBD-69B-HC**



**GBD-80B-HC**



**GBD-90B-HC**



**GBD-95B-HC**

## Features & Benefits

### System

- Energy-saving night curtains help maintain cabinet temperature (standard)
- Hot gas condensate system
- Automatic evaporation & defrost system

### Temperature

- Enhanced Airflow Holds Product Temperature 32°F~41°F (0°C~5°C)

### Components

- LED lighting interior display system provides bright and clear
- interior LED for excellent visibility
- 3" diameter stainless steel insulated beer tower (towers are optional)

### Slight Variations May Exist

### Strong & Durable Cabinet Finish

- Clean-looking white coated steel interior walls and deck
- Back coated exterior standard
- White coated steel shelves
- Modern and durable one-piece grill

### User Friendly Feature

- Door locks standard
- Sturdy and easy-grip handles and doors that open effortlessly
- Magnetic door gasket provides an easy-to-remove feature for cleaning or replacement feature
- Modern shaped glass door for the more excellent product display
- Efficient and economical size for tight workspace

### Options

- Standard magnificent black laminated exterior and galvanized steel interior
- Clean and simple looking stainless exterior interior
- 3", 4", or 5" diameter castors available
- Free HCFC & HFC refrigerant model (R-290)

# Plan View

**GBD-23B-HC**

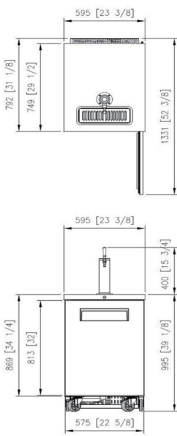

**GBD-56B-HC**

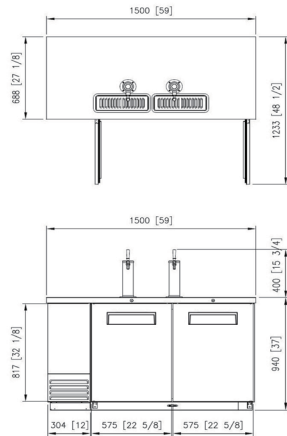

**GBD-69B-HC**

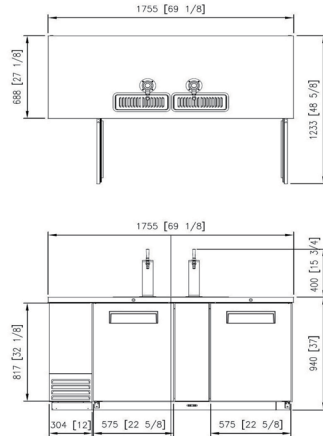

**GBD-80B-HC**

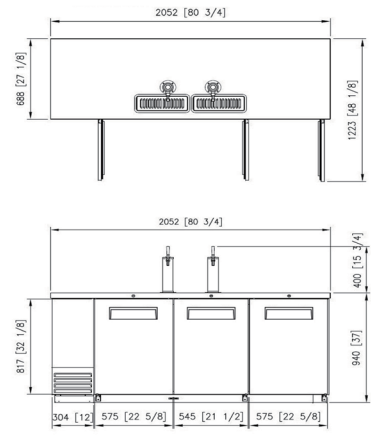

**GBD-90B-HC**

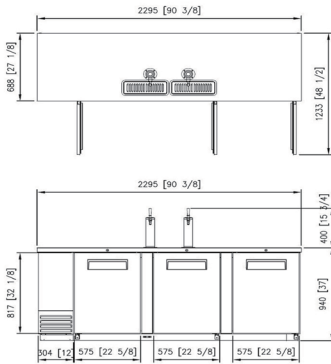

**GBD-95B-HC**

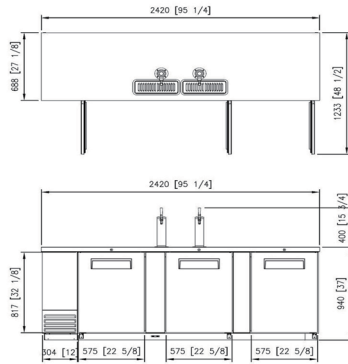

**ALL SIDE**

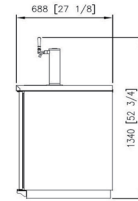

# Specifications

Model	Capacity (cu.ft/ ℓ)	Exterior Dimension (Inch/mm)			Net Weight (lb/kg)	Gross Weight (lb/kg)	Amps	Voltage (V/Hz/Ø)	HP	Refrigerant	No. Doors	No. Towers
		W	D	H								
GBD-23B -HC	7.9	23 3/8	31 1/8	39 1/8	126	132	3.3	115/60/1	1/5	R-290	1	1
	224	595	792	995	57	60	2.0	220/50,60/1				
GBD-59B -HC	19.4	59	27 1/8	37	216	236	4.2	115/60/1	3/8	R-290	2	2
	549	1,500	688	940	98	107	2.8	220/50,60/1				
GBD-69B -HC	23.4	69 1/8	27 1/8	37	240	265	5.2	115/60/1	3/8	R-290	2	2
	663	1,755	688	940	109	120	2.8	220/50,60/1				
GBD-80B -HC	27.9	80 3/4	27 1/8	37	273	302	5.2	115/60/1	3/8	R-290	3	2
	790	2,052	688	940	124	137	2.8	220/50,60/1				
GBD-90B -HC	31.6	90 3/8	27 1/8	37	298	331	6.3	115/60/1	3/8	R-290	3	2
	895	2,295	688	940	135	150	3.4	220/50,60/1				
GBD-95B -HC	33.6	95 1/4	27 1/8	37	311	346	6.3	115/60/1	3/8	R-290	3	2
	951	2,420	688	940	141	157	3.4	220/50,60/1				

\*GBD-23B-HC dimension includes 4" caster height \*\* External dimensions do not include caster and tower height (Casters are optional and towers are not provided) GRAND has the right to change specifications without further notice.



Grand Manufacturing LLC  
www.grandmfgllc.com

